

PLX537 - KIX537

PORTAVALIGIE LATERALE SPECIFICO - SPECIFIC TUBULAR SIDE-CASE HOLDER
 PORTE-VALISES LATÉRAUX SPÉCIFIQUE - SPÉCIFIQUES STAHLROHR-SEITENTRÄGER
 PORTA MALETAS LATERALES ESPECÍFICO

SUZUKI GSX1400 '06

ISTRUZIONI DI MONTAGGIO - MOUNTING INSTRUCTIONS
 INSTRUCTIONS DE MONTAGE - BAUANLEITUNG - INSTRUCCIONES DE MONTAJE

①

SUPPORTO
 SUPPORT
 SUPPORT
 HALTERUNG
 SOPORTE
Q.TY n.2(Dx-Sx)

②

PONTE POSTERIORE
 REAR BRIDGE
 PONT POSTÉRIEURE
 VERBINDUNGSROHR
 PUENTE TRASERO
Q.TY n.1

③

VITE TBEI M8x35mm
 SCREW M8x35mm
 VIS M8x35mm
 SCHRAUBE M8x35mm
 TORNILLO M8x35mm
Q.TY n.2

④

VITE TBEI M8x60mm
 SCREW M8x60mm
 VIS M8x60mm
 SCHRAUBE M8x60mm
 TORNILLO M8x60mm
Q.TY n.2

⑤

VITE TBEI M6x16mm
 SCREW M6x16mm
 VIS M6x16mm
 SCHRAUBE M6x16mm
 TORNILLO M6x16mm
Q.TY n.2

⑥

RONDELLA Ø8x14mm
 WASHER Ø8x14mm
 RONDELLE Ø8x14mm
 SCHIBE Ø8x14mm
 ARANDELA Ø8x14mm
Q.TY n.2

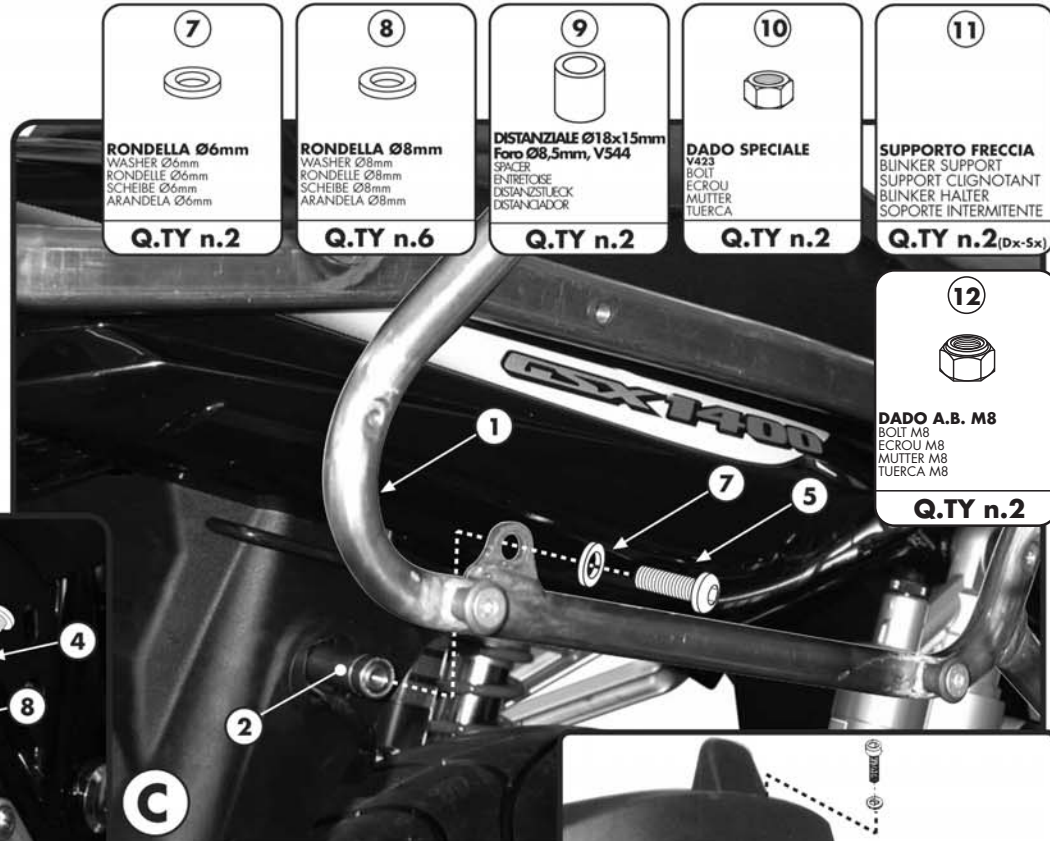
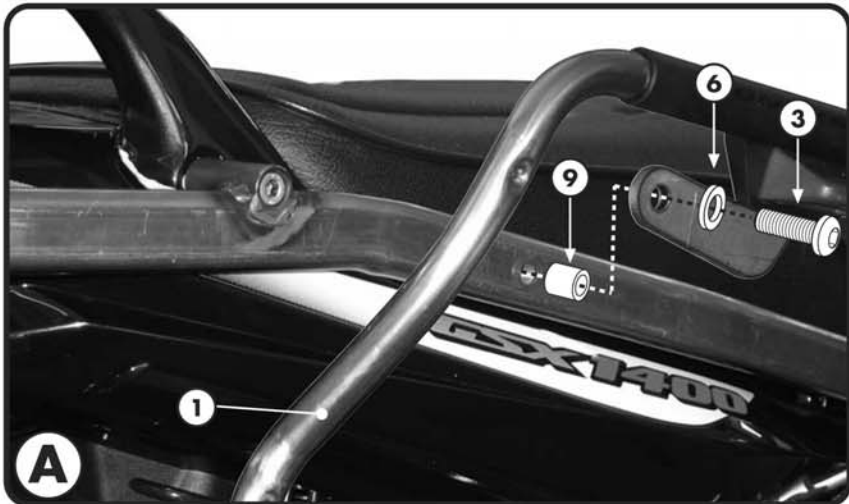

⑦

RONDELLA Ø6mm
 WASHER Ø6mm
 RONDELLE Ø6mm
 SCHIBE Ø6mm
 ARANDELA Ø6mm
Q.TY n.2

⑧

RONDELLA Ø8mm
 WASHER Ø8mm
 RONDELLE Ø8mm
 SCHIBE Ø8mm
 ARANDELA Ø8mm
Q.TY n.6

⑨

DISTANZIALE Ø18x15mm
 Foro Ø8,5mm, V544
 SPACER
 ENTRETÔISE
 DISTANZSTÜCK
 DISTANCIADOR
Q.TY n.2

⑩

DADO SPECIALE
 V423
 BOLT
 ECROU
 MUTTER
 TUERCA
Q.TY n.2

⑪

SUPPORTO FRECCIA
 BLINKER SUPPORT
 SUPPORT CLIGNOTANT
 BLINKER HALTER
 SOPORTE INTERMITENTE
Q.TY n.2(Dx-Sx)

⑫

DADO A.B. M8
 BOLT M8
 ECROU M8
 MUTTER M8
 TUERCA M8
Q.TY n.2

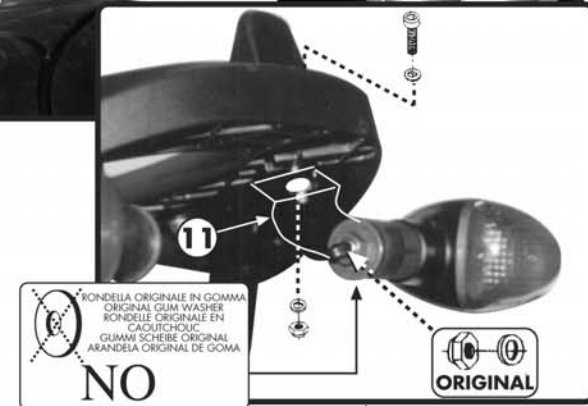
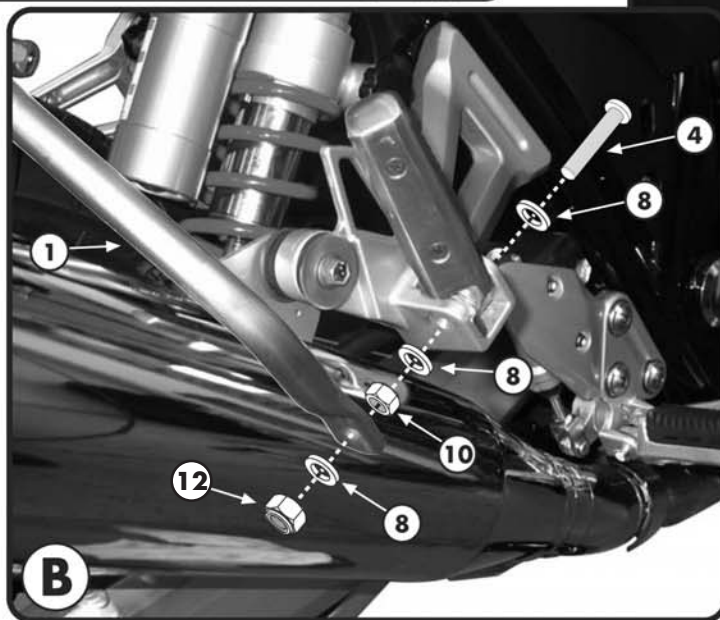

PLX537 - KLX537

PORTAVALIGIE LATERALE SPECIFICO - SPECIFIC TUBULAR SIDE-CASE HOLDER
PORTE-VALISES LATERAUX SPECIFIQUE - SPEZIFISCHES STAHLROHR-SEITENTRAEGER
PORTA MALETAS LATERALES ESPECIFICO

SUZUKI GSX1400 '06

ISTRUZIONI DI MONTAGGIO - MOUNTING INSTRUCTIONS
INSTRUCTIONS DE MONTAGE - BAUANLEITUNG - INSTRUCCIONES DE MONTAJE

I ISTRUZIONI DI MONTAGGIO

1. PROCEDERE AL MONTAGGIO DEL PORTAVALIGIE LATERALE COME INDICATO NELLE IMMAGINI A, B E C;
2. ULTIMARE IL MONTAGGIO CONTROLLANDO CHE TUTTE LE VITI SIANO SERRATE BENE.

GB MOUNTING INSTRUCTIONS

1. MOUNT THE SIDE-CASE HOLDER AS SHOWN IN THE PICTURES A, B AND C;
2. LASTLY CHECK THAT ALL SCREWS HAVE BEEN TIGHTENED.

F INSTRUCTIONS DE MONTAGE

1. PROCÉDER AU MONTAGE DES SUPPORTS VALISES COMME INDIQUE SUR LES IMAGES A, B, ET C.
2. TERMINER LE MONTAGE EN CONTRÔLANT LE BON SERRAGE DE TOUTES LES VIS.

D BAUANLEITUNG

1. MONTIEREN SIE DEN SEITENKOFFERTRÄGER WIE IN DEN BILDERN A, B UND C BESCHRIEBEN;
2. ZULETZT ÜBERPRÜFEN SIE DASS ALLE SCHRAUBEN FESTGEZOGEN WURDEN.

ES

INSTRUCCIONES DE MONTAJE

1. MONTAR EL PORTAMALETAS LATERAL COMO SE MUESTRA EN LAS FIGURAS A, B Y C;
2. SEGURARSE DE QUE TODOS LOS TORNILLOS HAN SIDO SUJETOS CORRECTAMENTE.