



Fitting Instruction

Article-No. : 118K105
Product : **Rear Set “2-Slide”**
Manufacturer : **Kawasaki**
Model : **ZX-10R 2004 - 2005**

Important:

Read this instruction manual carefully and mind all warnings and tips. You should do this work only if you're qualified; otherwise we recommend this mounting to be done by a qualified workshop. Improperly mounting of this kit can reduce the driveability of the motorcycle and may be a risk to your health and life.

Special works are marked with the following signs. Please take special care on these works.



Warning! Important mounting instruction. It shows risks to your life and health.



Tips for mounting and maintenance or to avoid damage.

Fitting:

Remove stock rear sets. The following parts will be used for your new rear set: screws to fix the stay and gearbox lever with ball joint and counter nut



Rear sets are pre-assembled but all screws are not tightened! Always use locknuts or proper amount of medium thread-locking adhesive (e.g. Loctite 243). All details of assembling are shown on the backside drawing. All parts are welded into their bags as they belong together.



Replace the original brake light switch by the hydraulic one. It replaces the screwing of the brake hose at the brake cylinder. **This is the highest point in the brake-system, proof proper air free installation!**



The original brake-hose has to be exchanged. A brake-hose with 590mm length and fittings with 20° and 20° sideward is required (LSL Article No.: 225BS59BE).

The tightening torques for connections to the frame refer to the manufacturer's instructions. Use the following torques for all other bolted connections:

M5	=	6Nm	=	4.43lbf ft
M6	=	10Nm	=	7.38lbf ft
M8	=	20Nm	=	14.75lbf ft
M10x1,25	=	30Nm	=	22.13lbf ft



After installing rear set **test brake and gear shifting at low speed. If anything is not operating properly or braking efficiency is poor, testing at high speeds may result in death or serious injury!**

Maintenance:



Periodically proof all functions during service intervals. Use **particle free (no MoS₂)** lithium or barium soap grease to maintain lever bushings.

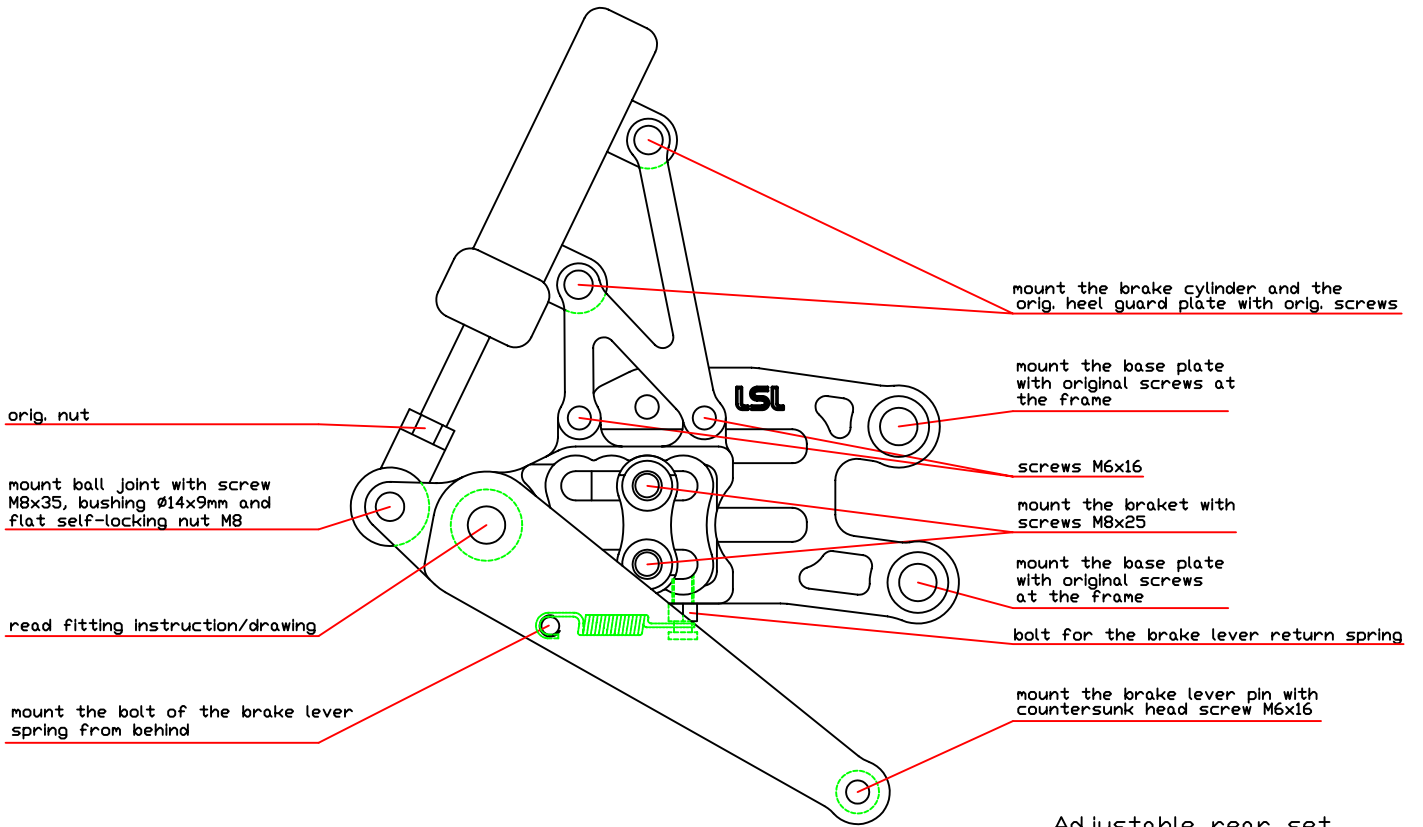

Adjustable rear set
ZX10-R since 2004
mounting drawing, brake

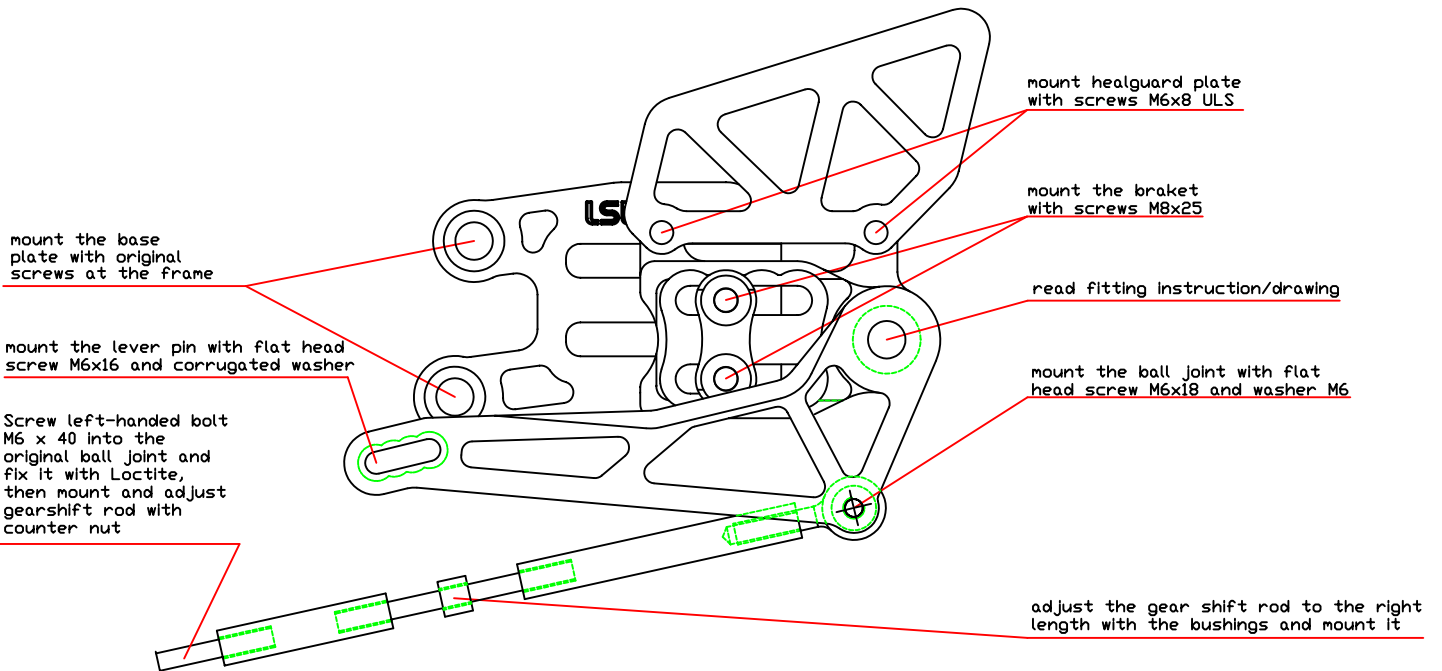

Adjustable rear set
ZX10-R since 2004
mounting drawing, gear shift

ULS M10x1.25x25

Schrauben-
sicherung
mittelfest
z.B.: Loctite 243

medium thread
locking adhesive
e.g. Loctite 243

Grundplatte

Stay

ggf. Paßscheibe verwenden
falls Hebel nicht beweglich

If lever is blocked use
shim ring

Scheibe $\varnothing 28\text{mm}$

Washer $\varnothing 28\text{mm}$

Brems/ Schalthebel

Brake pedal/ Shifter

Scheibe $\varnothing 25\text{mm}$

Washer $\varnothing 25\text{mm}$

Fett

Grease

starre Lagerung

Peg adapter

M5x20

