



Fitting Instruction

Article-No. : 118K107
Product : **Adjustable Rear Set**
Manufacturer : **Kawasaki**
Model : **ZX-6R & ZX-6RR 2005 - 2006**

Important:

Read this instruction manual carefully and mind all warnings and tips. You should do this work only if you're qualified; otherwise we recommend this mounting to be done by a qualified workshop. Improperly mounting of this kit can reduce the driveability of the motorcycle and may be a risk to your health and life.

Special works are marked with the following signs. Please take special care on these works.



Warning! Important mounting instruction. It shows risks to your life and health.



Tips for mounting and maintenance or to avoid damage.

Fitting:

Remove stock rear sets. The following parts will be used for your new rear set: gearbox lever with ball joint, bolts to fix the stay, perhaps the right heel protector and bolts to fix the brake cylinder.



Rear sets are pre-assembled but all screws are not tightened! Always use locknuts or proper amount of medium thread-locking adhesive (e. g. Loctite 243). All details of assembling are shown on the backside drawing. All parts are welded into their bags as they belong together.



The original brake light switch has to be replaced by a hydraulic one. It replaces the banjo bolt of the brake hose at the brake cylinder. **This is the highest point in the brake-system, proof proper air free installation! Use only seal rings according to the brake hose manufactures' instructions.**



The original brake-hose has to be exchanged. A brake-hose with 510mm length and fittings with 20° and 20° sideward is required (LSL Article No.: 225BS51BE).

The tightening torques for connections to the frame refers to the manufacturers' instructions. Use the following torques for all the other screw connection:

M5	=	6Nm	=	4.43lbf ft
M6	=	10Nm	=	7.38lbf ft
M8	=	20Nm	=	14.75lbf ft
M10x1.25	=	30Nm	=	22.13lbf ft



After installing rear set **test brake and gear shifting indoor. If anything is not operating properly or braking efficiency is poor, testing on the road may result in death or serious injury!**

Maintenance:



Periodically proof all functions during service intervals. Use **particle free (no MoS₂)** lithium or barium soap grease to maintain lever bushings.

Special note:

The position of the reservoir depends on the individual position: The new bracket is necessary to prevent the hose from crushing if one of the three backward positions on the upper slide is used

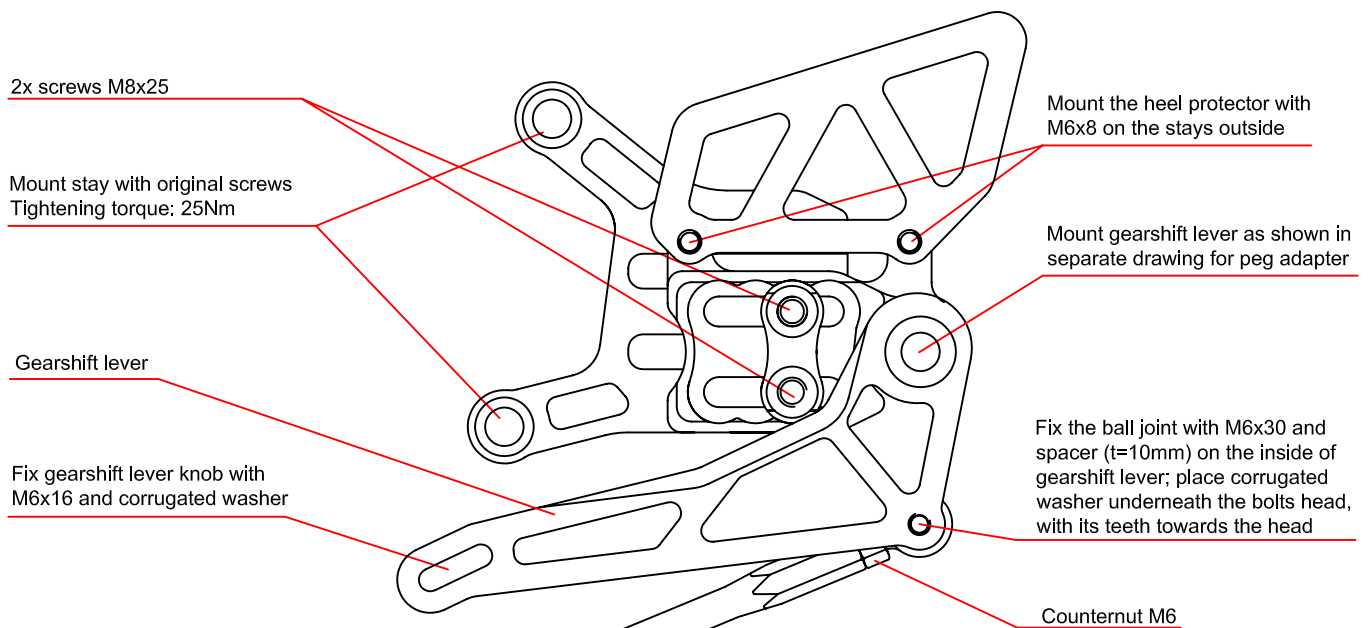
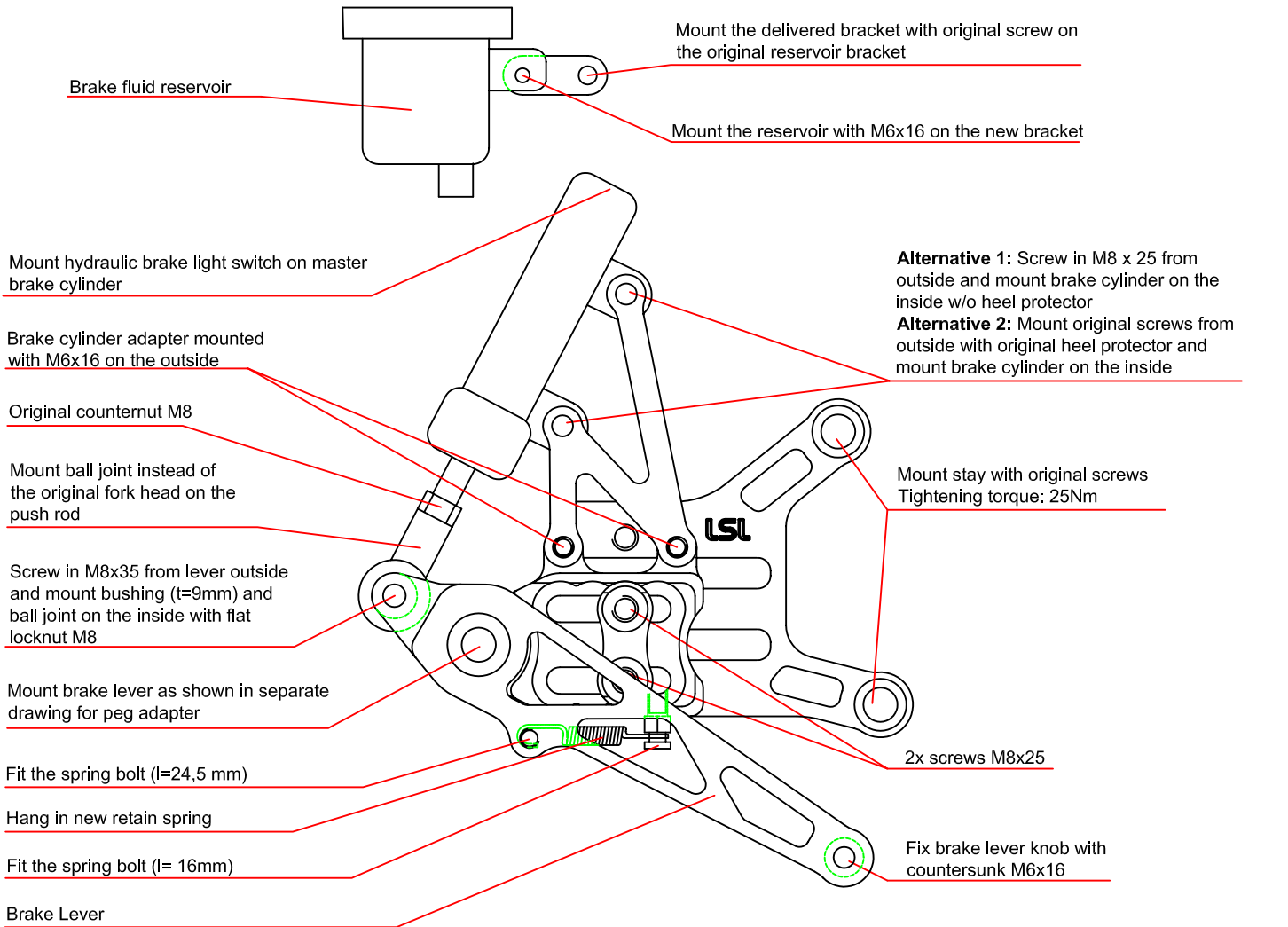

Advice: To reverse the shifting sequence it is necessary to remove or cut the sprocket cover

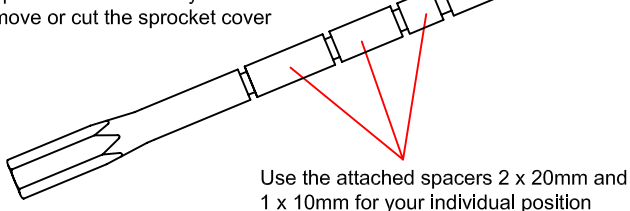

Adjustable Rear-Set
Kawasaki ZX-6R/RR '05 - '06

ULS M10x1.25x25

Schrauben-
sicherung
mittelfest
z.B.: Loctite 243

prod. blocage
de sécurité
p.ex. Loctite 243

medium thread
locking adhesive
e.g. Loctite 243

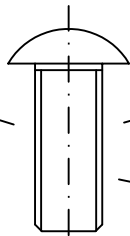

Grundplatte

Plaque de fixation
Hanger

ggf. Paßscheibe verwenden
falls Hebel nicht beweglich

Utilisez rondelle de calage si le
levier n'est pas mobile
If lever is blocked use
shim ring

Scheibe Ø28mm

Rondelle / Washer Ø28mm

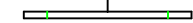
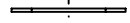
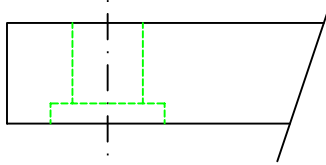

Brems- / Schalthebel

Sélecteur/pédale frein
Brake pedal/ Shifter

Scheibe Ø25mm

Rondelle / Washer Ø25mm

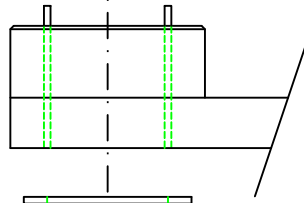

Fett

Graisse / Grease

starre Lagerung

Axe de fixation
Journal

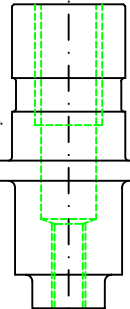

Fußraste

Footpeg

Support de pieds

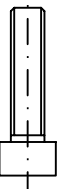
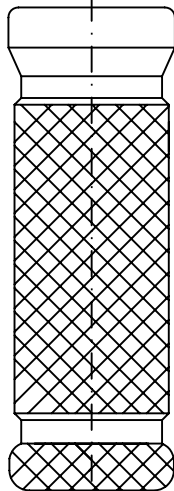

M5x25