



Fitting Instruction

Article-No. : **110K083 & 110K083T (ZX-6R)**
110K084 & 110K084T (ZX-9R)
Product : **Rear Set**
Manufacturer : **Kawasaki**
Model : **ZX-9R 1998 - 1999**
ZX-6R 1998 - 1999

Important:

Read this instruction manual carefully and mind all warnings and tips. You should do this work only if you're qualified; otherwise we recommend this mounting to be done by a qualified workshop. Improperly mounting of this kit can reduce the driveability of the motorcycle and may be a risk to your health and life.

Special works are marked with the following signs. Please take special care on these works.



Warning! Important mounting instruction. It shows risks to your life and health.



Tips for mounting and maintenance or to avoid damage.

Fitting:

Remove stock rear sets. The following original parts will be used for your new rear set: gearbox lever with ball joint and counternut, left and right heel protector, brake light switch with its spring, brake lever retain spring, bolts to fix the stays, brake cylinder and left heel protector.



Rear sets are pre-assembled but all screws are not tightened! Always use locknuts or proper amount of medium thread-locking adhesive (e. g. Loctite 243). All details of assembling are shown on the backside drawing. All parts are welded into their bags as they belong together.

The tightening torques for connections to the frame refers to the manufacturers' instructions. Use the following torques for all the other screwing:

M5	=	6Nm	=	4.43lbf ft
M6	=	10Nm	=	7.38lbf ft
M8	=	20Nm	=	14.75lbf ft
M10x1,25	=	30Nm	=	22.13lbf ft



After installing your new rear set **test brake and gear shifting at low speed. If anything is not operating properly or braking efficiency is poor, testing at high speeds may result in death or serious injury!**

Maintenance:



Periodically proof all functions during service intervals. Use **particle free (no MoS₂)** lithium or barium soap grease to maintain lever bushings.

Master brake cylinder

Use original bolts and heel protector and mount brake cylinder on the outside

Original counternut M8

Mount ball joint instead of the original fork head on the push rod. To reach a deep lever position it may be necessary to shorten the push rod

Screw in M8x35 from lever outside and mount bushing (t=9mm) and ball joint on the inside with flat locknut M8

Mount brake lever as shown in separate drawing for peg adapter

Screw in M6x18 from outside and mount bushing (t=3mm) and spring-bracket bolt on the inside

Mount brake light switch bracket with M5x8 from behind

Brake cylinder adapter

Brake cylinder adapter mounted on the inside with M6x18 from behind

Fix spring with M5x20

Stay

Mount stay with original screws

Original retain spring

Brake Lever

Fix brake lever knob with countersunk M6x16

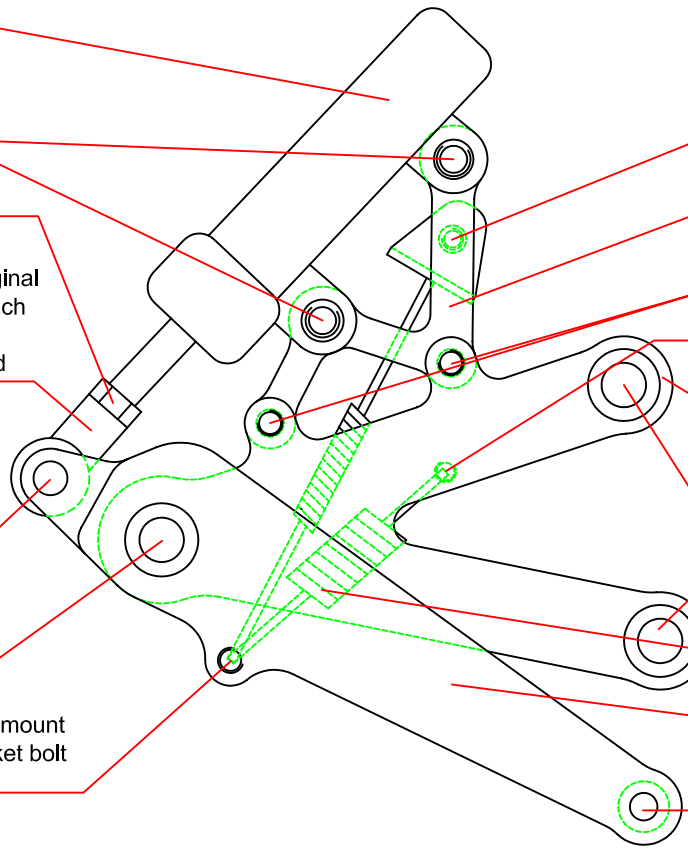

Mount stay with original screws

Stay

Gearshift lever

Fix gearshift lever knob with countersunk M6x16

Mount the original heel protector with original screws on the stays outside

Mount gearshift lever as shown in separate drawing for peg adapter

Fix the ball joint with M6x16 on the inside of gearshift lever

Ball joint M6 with counternut

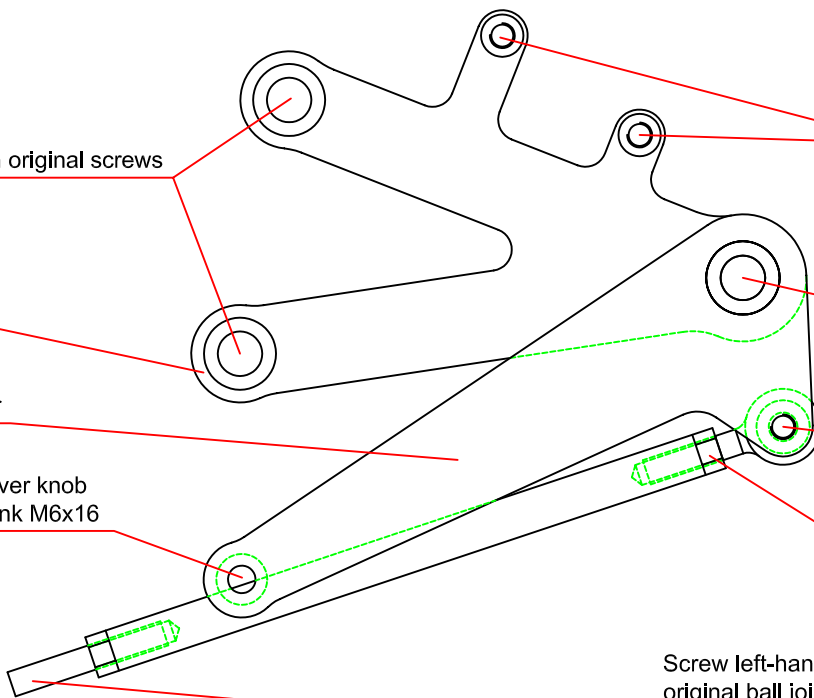

Screw left-hand thread bolt M6x40 into the original ball joint and fix it with Loctite, then mount and adjust gearshift rod with original counternut

