



Thank you for buying a LSL product. Because of our passion for motorcycles all our products are designed to meet your needs as a motorcyclist. We wish you always a safe and pleasant ride with your new LSL product from Paaschburg & Wunderlich GmbH.

Before installing please read this manual carefully.

The installation shall be conducted in a professional manner. If the installation violates the professional standard, the liability for the product is lost. Check the manual and requirements from the manufacturer of your motorcycle regarding modification or change of mirrors. This is mandatory due to safety. Unauthorized change may endanger your safety. If uncertain about the installation please hire a qualified person. Please keep this manual for a later use.

Scope of delivery:

- 1 pc. LSL ERGONIA mirror (C)
- 3 pcs. Centering sleeves (K1), (K2), (K3) (Fig.1)
- Mounting kit with two damp sleeves (E1) + (E2), conical nut (H), central allen screw (F) (Fig.1)

1. The LSL mirror "ERGONIA" is suitable for the right and left side, but might need to be modified. The "ERGONIA" mirror fits on most common handle bars with an inner diameter of 12 mm to 21 mm (that means most aluminium and steel handle bars with an outer diameter of 7/8" (22 mm) to 1" (25,4 mm)).
2. Choose the correct damp sleeve (E1) (E2) and correct centering sleeve (K1) (K2) (K3) for your handle bar and either install it on the right or left side.
 - Inner handle bar diameters from 12 mm to max. 13,9 mm: Use sleeve (E1).
 - Inner handle bar diameters from 14 mm to max. 15,9 mm: Use sleeve (E1)+(K1).
 - Inner handle bar diameters from 16 mm to max. 17,9 mm: Use sleeve (E1)+(E2).
 - Inner handle bar diameters from 18 mm to max. 20,9 mm: Use sleeve (E1)+(E2)+(K2).
 - Inner handle bar diameter 21 mm: Use sleeve (E1)+(E2)+(K3).
3. Secure all screws and nuts with screw locking (not included).
4. The damping sleeves (E1) (E2) and, if necessary, the matching centering sleeve (K1) (K2) (K3) must now be mounted again on the central allen screw (F) as shown in Figure 1. Now slightly bias the sleeve with the aid of the central screw (F) so that it can be just pushed into the steering tube (Fig. 3). If necessary, hold the cone nut (H) with pliers. The mirror arm should rest flat against the end of the steering tube.
5. **CAUTION:** Make sure that the throttle is not being jammed and can still turn freely! Risk of accident! Before each ride, make sure to adjust the mirrors so that a good rear view is guaranteed.
6. After the mirror has been installed, reattach the cap covering the central allen screw.
7. To remove the cap covering the central allen screw, apply slight airpressure to the small hole in order to pop out the cap (Fig.2).
8. Before starting your journey, adjust the mirror so that you have a good rear view.
9. Make sure that the mirror or the mirror arm does not obstruct the operation of the vehicle or any attachments, in particular the function of the throttle sleeve must not be impaired.

Before every journey:

It is the duty and responsibility of the rider to regularly check and maintain the safety-related vehicle parts. Check the proper adjustment and function of the product and the tightness of all screwed connections before each journey.

Warranty:

Take your time to do a professional job in assembling and mounting the product. Take into account all our installation and safety instructions. A faulty, improper installation or handling of the product will void the warranty.

Care:

Do not use aggressive detergents to care for the product. The product can be perfectly cleaned with a simple, lukewarm detergent solution. Contact with brake fluid, brake cleaner, fuel, etc. should be avoided. Immediately pick up any unintentionally applied impurities with a soft cloth and clean the surface with detergent solution.

Environmental Information:

This product must not be disposed in the normal household rubbish at the end of its lifetime.

The disposal can be done through the Paaschburg u. Wunderlich customer service or a local return and waste collection institution.

Find useful additional accessories like housings, indicators, taillights, resistors, electronic relays, adapter cables and other equipment in our Webshop!

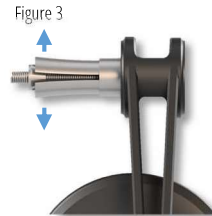
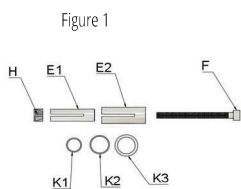

Dimensions:

- A: 100 mm
- B: 100 mm
- C: 30 mm
- D: 165 mm

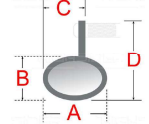
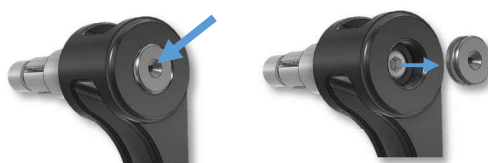

Figure 4



Figure 5



www.LSL.eu

Exclusion of liability and guarantee regulation:

In case of inappropriate use or installation of the device, all guarantee claims and liability for direct or indirect or subsequent damage become invalid. Paaschburg & Wunderlich GmbH is not liable for any damage resulting usage, installation or connecting of the device. In particular the liability on damage to person and financial loss is excluded. The use of the device in public traffic is at owner's risk solely.

Paaschburg & Wunderlich GmbH, Am Alten Lokschnuppen 10a, D-21509 Glinde
Tel.: +49 (0) 40 248 777-0; E-Mail: sales@pwnline.de

All rights reserved. Changes and errors are accepted.
#132SERG1A_2019-10